

ROLLER SHADES

LIFT SYSTEM: CONTINUOUS CORD LOOP



The difficulty level of this installation is ranked at **Level 2**. *You got this!*

If you have questions or get stuck, call our Customer Care Team at 888-685-1735, or email info@selectblindscanada.ca.

HARDWARE AND PARTS INCLUDED

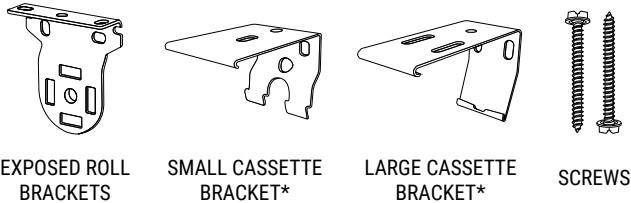

EXPOSED ROLL BRACKETS

SMALL CASSETTE BRACKET*

LARGE CASSETTE BRACKET*

SCREWS

*The quantity of brackets you receive will depend on the width of your cassette headrail.

TOOLS REQUIRED

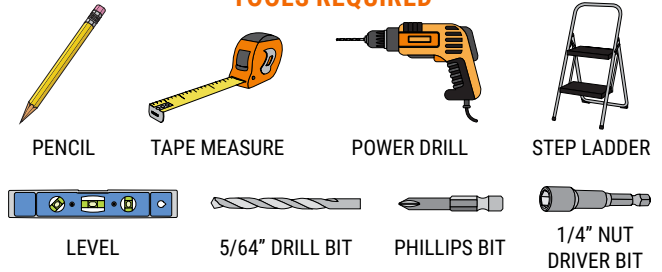

PENCIL

TAPE MEASURE

POWER DRILL

STEP LADDER



LEVEL



5/64" DRILL BIT



PHILLIPS BIT



1/4" NUT DRIVER BIT

1. MOUNTING THE BRACKETS

EXPOSED ROLL BRACKETS

NOTE: Exposed roller shades with a chain loop have identical brackets, and are mounted in or above the top corners of your window. Simply decide which bracket will be on the left side of your window, and which will be on the right. **DO NOT** remove the paper band that wraps around your roller until after the shade is installed.

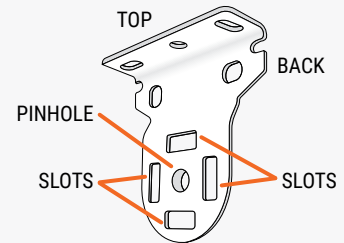

EXPOSED ROLL - INSIDE MOUNT

1. At the top-right corner of the window, measure how deep you wish to place your brackets (at least 2 1/4" required), and make a mark with your pencil. Repeat this step at the top-left corner of the window, using the same depth measurement.
2. Set your left-side bracket in the window so that the back edge aligns with your mark. Hold the bracket in position and use your pencil to mark through either the top screw holes (**TOP MOUNT**), or the back screw holes (**SIDE MOUNT**). Repeat this with your right-side bracket.
3. Pre-drill holes with a 5/64" drill bit at your previous marks on each side of the window.
4. Line up each bracket with the holes you drilled, and insert the screws. Once you have secured both brackets, you're ready to mount the shade (see page 4).

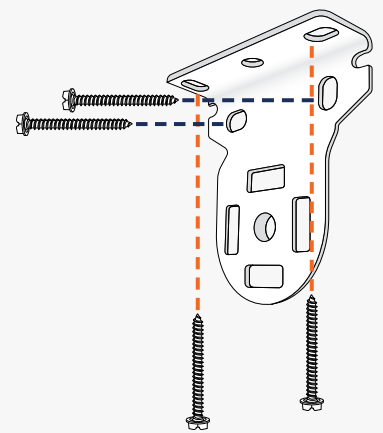
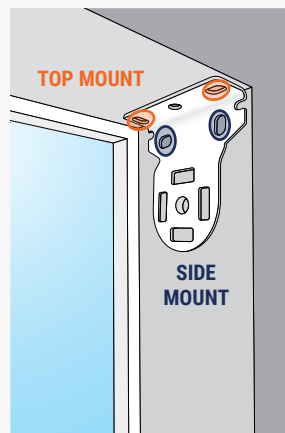
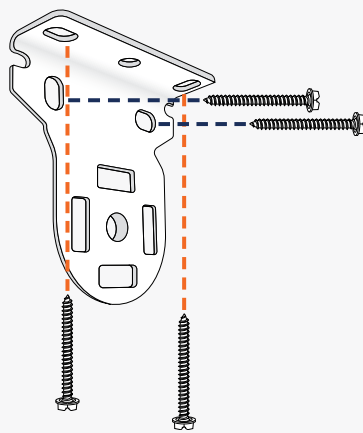
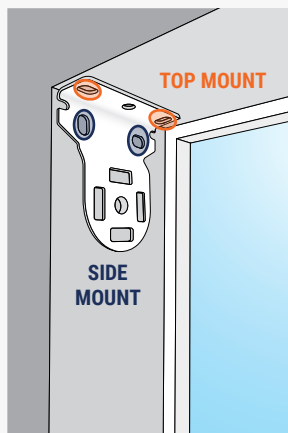
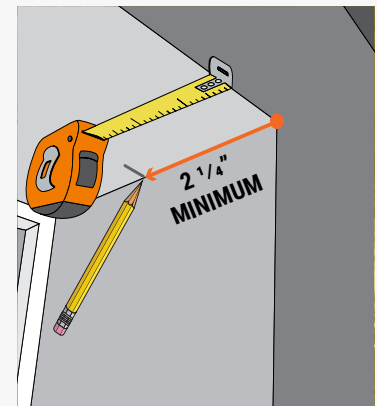

EXPOSED ROLL - OUTSIDE MOUNT

1. At the top-left and top-right corners of the window, measure the height you wish to place your brackets (at least 2" required) and make a mark with your pencil.

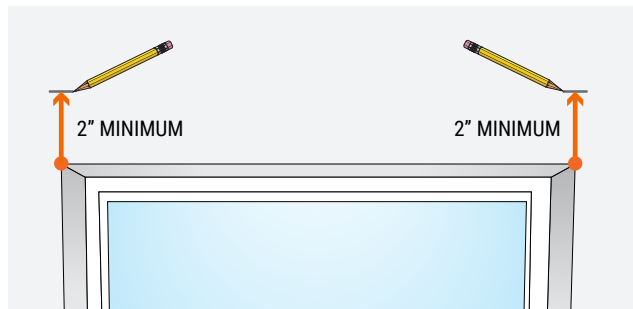

2. Determine the difference in width between your shade and your window, and then divide it in half. From your previous marks, measure this distance away from the window, and make another mark with your pencil.



EXAMPLE: If your window is 48" wide and your roller shade is 52", the difference is 4". This means we measure and mark 2" away from the window, starting at the previous marks.

3. Center the left-side bracket at the outermost mark as shown, and use your pencil to mark the screw holes. Repeat this step with your right-side bracket at the outer-right mark.

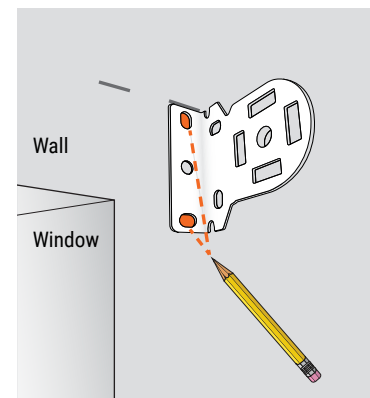
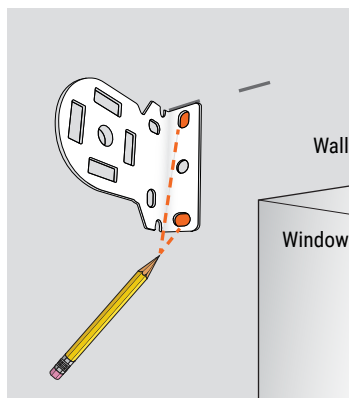

4. Pre-drill the screw holes with a 5/64" drill bit at your marks on both sides of the window. Before you attach the brackets, you may want to erase any pencil marks that remain on the mounting surface.

5. Line up your left-side bracket with the screw holes, and insert two screws to secure the bracket to the mounting surface. Repeat this step for your right-side bracket. When both brackets are secure, the next step is to set the roller shade in the window (see page 4).

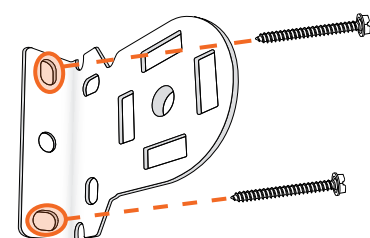
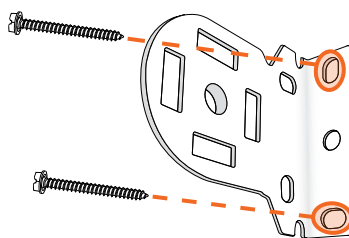

MOUNTING CASSETTE HEADRAIL BRACKETS

NOTE: The roller shade tube is pre-installed in the cassette headrail, which simply snaps onto the provided hardware. You will receive two or more cassette brackets, depending on the width of your shade. The steps for mounting **STANDARD** and **LARGE CASSETTE BRACKETS** are the same.

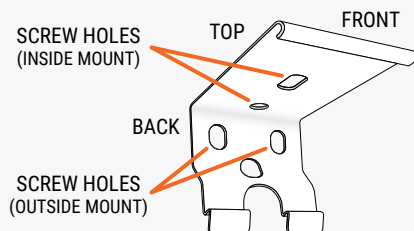

STANDARD CASSETTE BRACKET

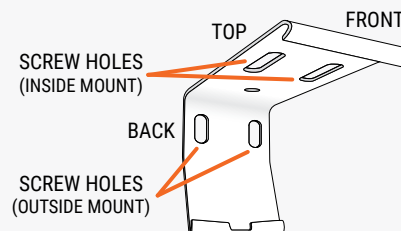

LARGE CASSETTE BRACKET

CASSETTE HEADRAIL - INSIDE MOUNT

1. At the top corners of the window, measure inward and mark with your pencil 2" - 4" from each side. If you have additional brackets, make an additional mark for each one, evenly spaced between the outer marks.



2. Next, you'll need to measure how deep to place your brackets in the window. Starting at one of your marks, measure back at least 2 1/4", and make a mark with your pencil. If you want the front of the cassette to be flush with the wall, measure back 3" and make a mark. Repeat this step until you've marked the same depth measurement for each bracket.

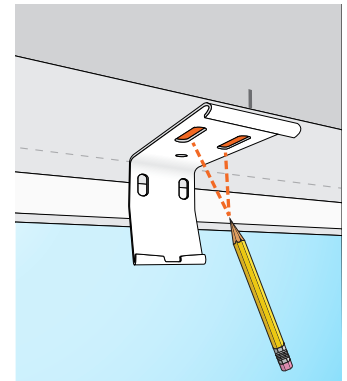
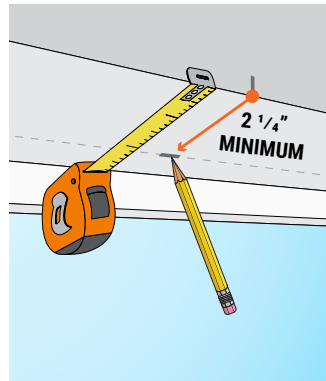

3. Position a bracket at the top of the window so that the back aligns with your mark. Make sure the front end of the bracket is parallel with the top edge of the window, then use your pencil to mark where the screws will go. Repeat this step until you've marked the screw holes for each bracket.

4. Pre-drill the screw holes with a 5/64" drill bit at your marks for each bracket location. Before you mount the brackets, you may want to erase any pencil marks that remain on the wall or window.

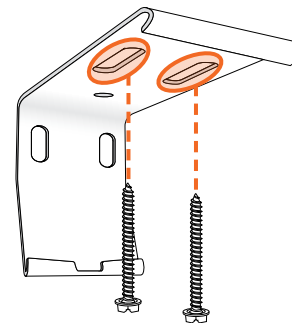

5. Line up your first bracket with the screw holes, and insert two screws to secure the bracket to the mounting surface. Repeat this step for any remaining brackets. When all brackets are secure, the next step is to set the roller shade in the window (see page 4).

CASSETTE HEADRAIL - OUTSIDE MOUNT

1. At the top corners of the window, measure inward and mark with your pencil 2" - 4" from each side. If you have additional brackets, make an additional mark for each one, evenly spaced between the outer marks.

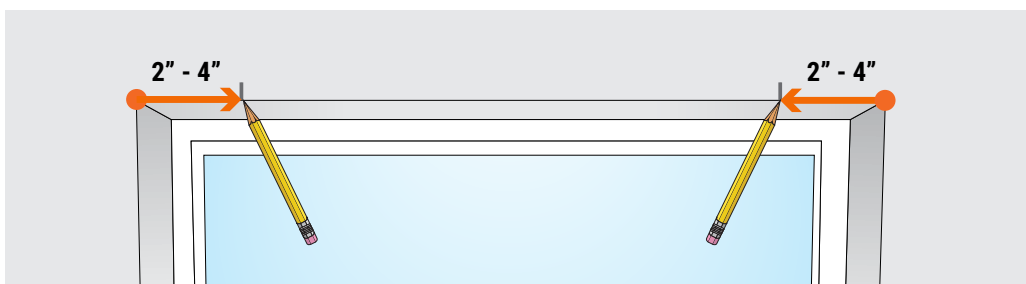

2. From one of these marks, measure upward and mark the height for the bracket placement. The minimum requirement is 1", but if you want the brackets to clear the top of the window, measure and mark at least 2 1/4" above your window. Repeat this until you've marked the same height measurement for each bracket.

3. Position a bracket so that the back is against your mounting surface, and the top is aligned with one of your upper marks. Hold the bracket in place and mark with your pencil where the screws will go. Repeat this until you've marked the screw holes for each bracket.

4. Pre-drill the screw holes with a 5/64" drill bit at your marks for each bracket location. Before you mount the brackets, you may want to erase any pencil marks that remain on the mounting surface.

5. Line up your first bracket with the screw holes, and insert two screws to secure the bracket to the mounting surface. Repeat this step for any remaining brackets. When all brackets are secure, the next step is to set the roller shade in the window.

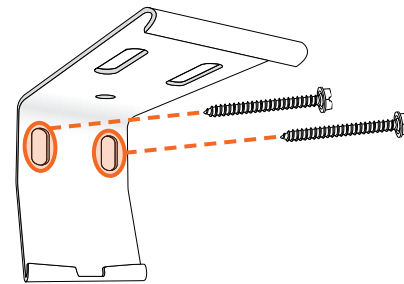
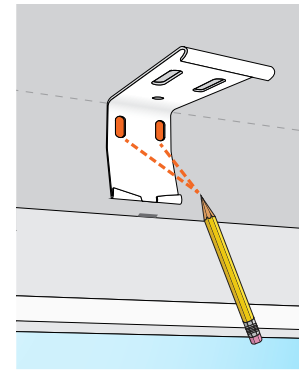
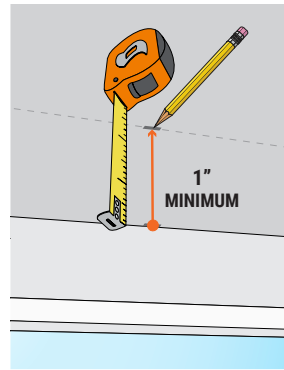

2. ATTACHING THE SHADE

NOTE: Before you attach the shade to the brackets, check that your brackets are straight and aligned with each other. The screw holes on all brackets are elongated, so making small adjustments is easy.

Inside Mount: Use a tape measure to check that each bracket is set to the same depth. If you need to make adjustments, slightly loosen the screws on a bracket and shift it back or forward. Secure the screws when the position is corrected.

Outside Mount: Use a tape measure to check that each bracket is set to the same height, and use a level on top of each bracket to make sure they're all straight and aligned. If you need to make adjustments, slightly loosen the screws on a bracket and shift it until it's level and set to the correct height.

EXPOSED ROLL

NOTE: One end of your shade has a compressible pin, and the other end has the chain loop. If your chain is on the right end of your shade, the pin end will be installed to the left bracket. If your chain is on the left, the pin will be installed to the right bracket.

1. Hold your shade up to the window, and insert the pin through the pinhole on the correct bracket.

2. While keeping the pin attached securely to its bracket, find the two tabs on the other end of your shade, and insert them through the slots on the opposite bracket. When the shade is installed, you may safely remove the paper band wrapped around the roller.

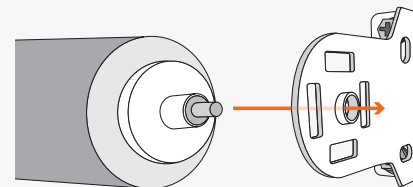
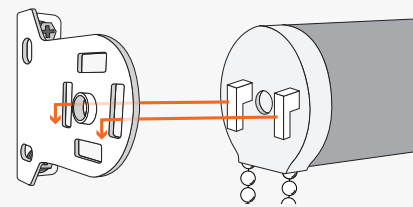

CASSETTE HEADRAIL

1. Grab the cassette and hold it up to your brackets. Set the back edge of the headrail onto the bottom tab of each bracket. While in this position, you can slide the shade left or right until the cassette is centered.

2. When you're ready to secure the headrail, push the headrail back until the top of each bracket snaps onto the top of the cassette. When the shade is installed, you may safely remove the paper band wrapped around the roller.

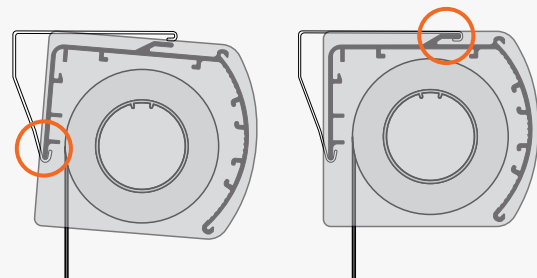

3. ADDITIONAL INSTRUCTIONS

INSTALLING CHAIN TENSIONER

NOTE: Chain tensioners are used to ensure the smooth operation of your shade and to help protect children from getting tangled in loose cords. The goal is to make the chain taut, but still slightly loose.

1. Pinch the tensioner to release its grasp on the chain. Pull it to the bottom of the cord loop while keeping it pinched together.

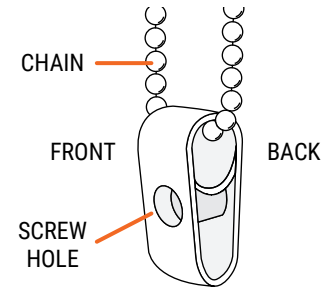

INSIDE MOUNT

- A. Place the tensioner against the inside of the window and keep the cord pulled tightly. Shift it up about 1/8", then make a mark at the screw hole.
- B. Move the cord away and use the marks to pre-drill screw holes with a 5/64" drill bit.
- C. Align the tensioner with the pre-drilled holes and fasten the 1-1/4" screws, being careful NOT to over-tighten the screws.

OUTSIDE MOUNT

- A. Place the tensioner against the wall while keeping the cord pulled tightly. Shift it up about 1/8", then make a mark at the screw hole.
- B. Move the cord away and use the marks to pre-drill screw holes with a 5/64" drill bit.
- C. Align the tensioner bracket with the holes and fasten the 1-1/4" screws, being careful NOT to over-tighten the screws.

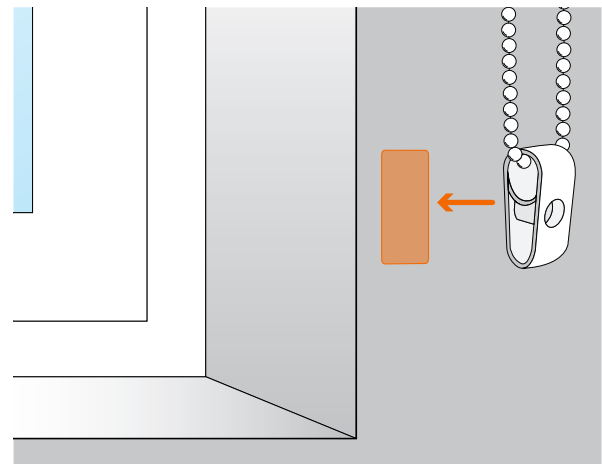
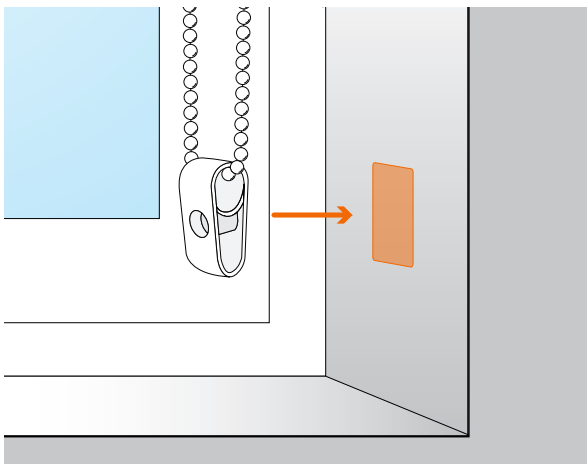

2. Now just test to make sure the shade operates properly. Pull on the front of the chain loop to raise the shade, and pull on the back of the chain loop to lower the shade.

ADJUSTING MISALIGNED FABRIC

TIP: If your shade doesn't roll straight, first make sure the brackets are level. If it veers to the right, lower the shade completely and place a piece of tape or business card as close to the left edge of the roller as possible. This acts like a shim to align and straighten the shade. If it veers to the left, place the tape or card as close to the right edge as you can. Repeat this tip until the shade raises and lowers evenly.

ROLLER SHADES

LIFT SYSTEMS: CORDLESS LIFT | PREMIUM CORDLESS LIFT



The difficulty level of this installation is ranked at **Level 2**. *You got this!*

If you have questions or get stuck, call our Customer Care Team at 888-685-1735, or email info@selectblindscanada.ca

HARDWARE AND PARTS INCLUDED

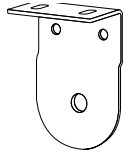

EXPOSED ROLL
PIN BRACKET

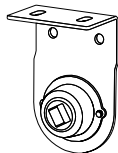

EXPOSED ROLL
IDLE BRACKET

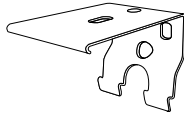

SMALL CASSETTE
BRACKET*

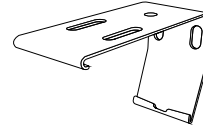

LARGE CASSETTE
BRACKET*

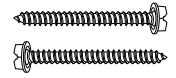

SCREWS

*The quantity of brackets you receive will depend on the width of your cassette headrail.

TOOLS REQUIRED



PENCIL



TAPE MEASURE



POWER DRILL



5/64" DRILL BIT



PHILLIPS BIT



1/4" NUT DRIVER BIT



LEVEL



FLATHEAD
SCREWDRIVER



STEP LADDER

1. MOUNTING THE BRACKETS

EXPOSED ROLL BRACKETS CORDLESS LIFT

NOTE: Before you begin installing idle and pin brackets, it's important to determine which bracket belongs on the left, and which belongs on the right. Use the guide below to determine how your brackets will need to be positioned in the window.

DO NOT remove the paper band that wraps around your roller until after the shade is installed.

Standard Roll: Install your shade in the **STANDARD ROLL POSITION** if the fabric hangs from the back of the roller tube. The idle bracket will be placed on the left side of the window, and the pin bracket will be placed on the right side of the window.

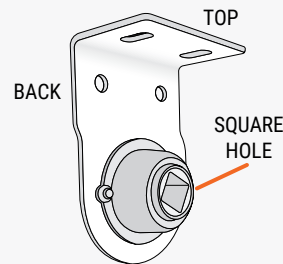

IDLE BRACKET

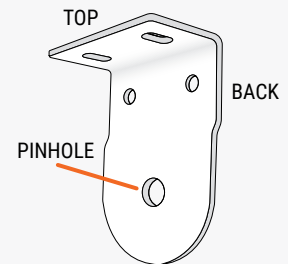

PIN BRACKET

Reverse Roll: If the fabric hangs from the front of the roller tube, install your shade in the **REVERSE ROLL POSITION**. The idle bracket will be placed on the right side of the window, and the pin bracket will be placed on the left side of the window.

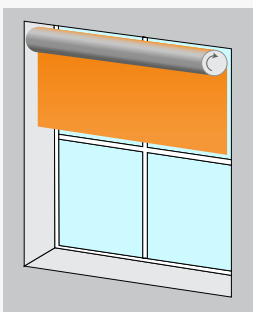

STANDARD ROLL POSITION

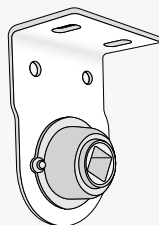

LEFT BRACKET

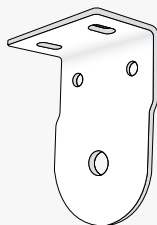

RIGHT BRACKET

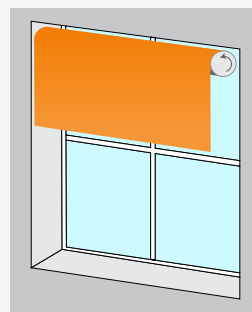

REVERSE ROLL POSITION

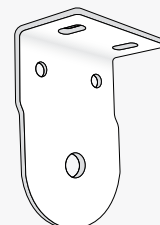

LEFT BRACKET

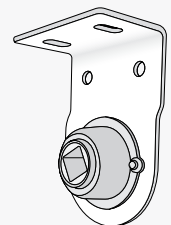

RIGHT BRACKET

EXPOSED ROLL - INSIDE MOUNT

NOTE: Before you begin, make sure you've identified your left and right brackets using the guide on page 6.

1. At the top-right corner of the window, measure how deep you wish to place your brackets (at least 2 1/4" required), and make a mark with your pencil. Repeat this step at the top-left corner of the window, using the same depth measurement.
2. Set your right-side bracket in the window so that the back edge aligns with your mark. Hold the bracket in position and use your pencil to mark through either the top screw holes (**TOP MOUNT**), or the back screw holes (**SIDE MOUNT**). Repeat this with your left-side bracket.
3. Pre-drill holes with a 5/64" drill bit at your previous marks on each side of the window.
4. Line up each bracket with the holes you drilled, and insert the screws. Once you have secured both brackets, you're ready to mount the shade (see page 10).

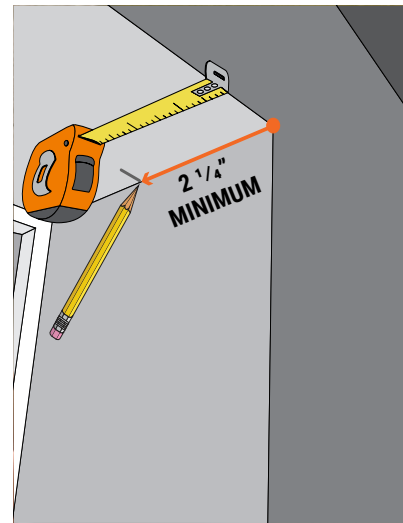

Example shown: Standard Roll - Idle Bracket (Left)

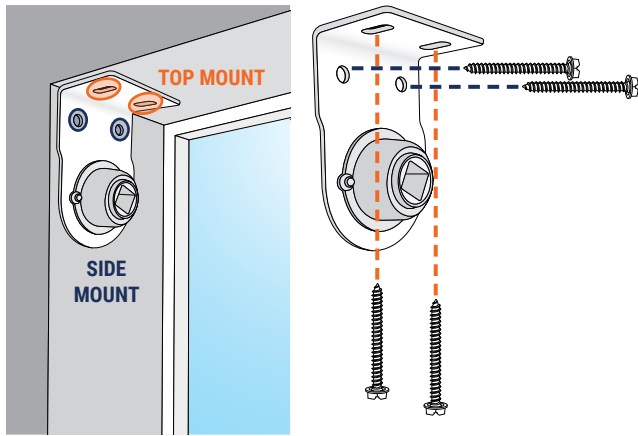

Example shown: Standard Roll - Pin Bracket (Right)

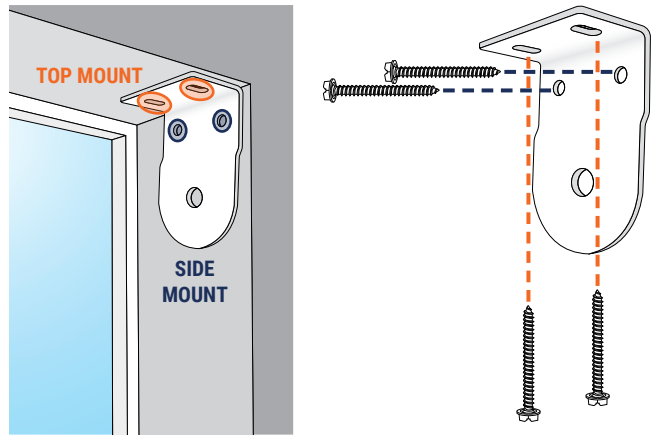

EXPOSED ROLL - OUTSIDE MOUNT

NOTE: The steps for mounting an exposed roll shade are the same, regardless of the bracket-style you received. Before you begin, make sure you've identified your left and right brackets using the guide on page 6.

1. At the top-left and top-right corners of the window, measure the height you wish to place your brackets (at least 2" required) and make a mark with your pencil.
2. Determine the difference in width between your shade and your window, and then divide it in half. From your previous marks, measure this distance away from the window, and make another mark with your pencil.

EXAMPLE: If your window is 48" wide and your roller shade is 52", the difference is 4". This means we measure and mark 2" away from the window, starting at the previous marks.

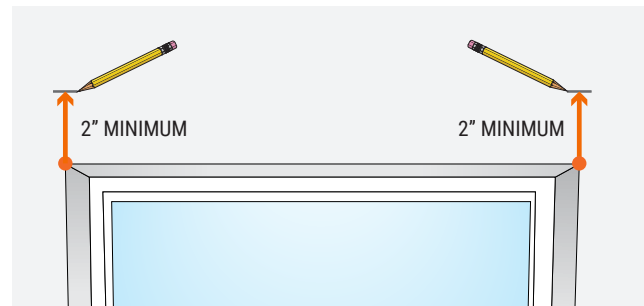

3. Center the right-side bracket at the outermost mark as shown, and use your pencil to mark the screw holes. Repeat this step with your left-side bracket at the outer-left mark.

4. Pre-drill the screw holes with a 5/64" drill bit at your marks on both sides of the window. Before you attach the brackets, you may want to erase any pencil marks that remain on the mounting surface.

5. Line up your right-side bracket with the screw holes, and insert two screws to secure the bracket to the mounting surface. Repeat this step for your left-side bracket. When both brackets are secure, the next step is to set the roller shade in the window (see page 10).

Example shown:
Standard Roll - Idle Bracket (Left)

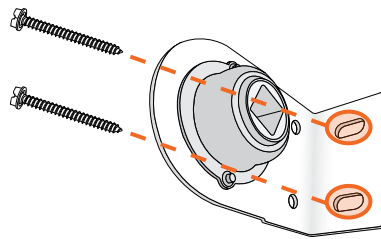
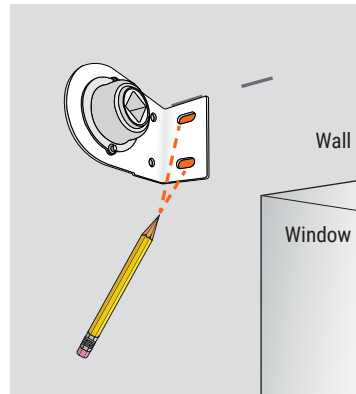

Example shown:
Standard Roll - Pin Bracket (Right)

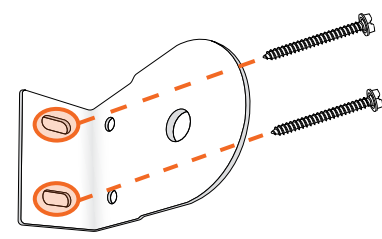
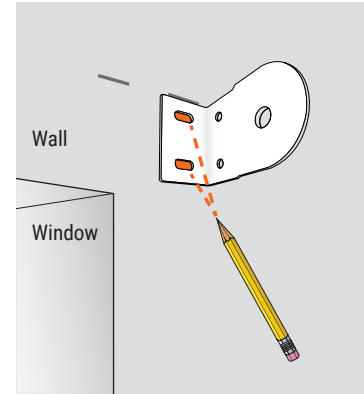

MOUNTING CASSETTE HEADRAIL BRACKETS PREMIUM CORDLESS LIFT

NOTE: The roller shade tube is pre-installed in the cassette headrail, which simply snaps onto the provided hardware. You will receive two or more cassette brackets, depending on the width of your shade. The steps for mounting **STANDARD** or **LARGE CASSETTE BRACKETS** are the same.

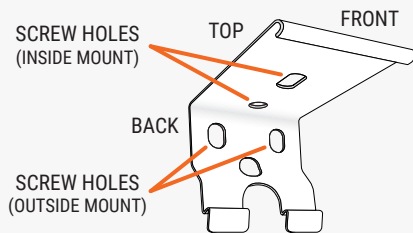

STANDARD CASSETTE BRACKET

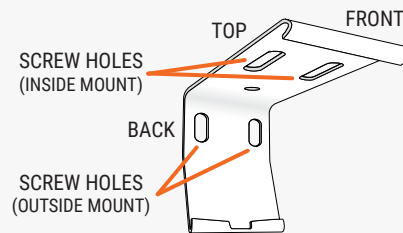

LARGE CASSETTE BRACKET

CASSETTE HEADRAIL - INSIDE MOUNT

1. At the top corners of the window, measure inward and mark with your pencil 2" - 4" from each side. If you have additional brackets, make an additional mark for each one, evenly spaced between the outer marks.

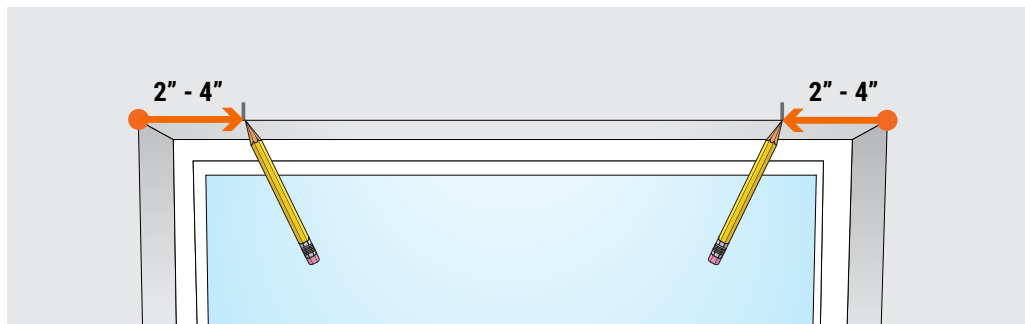

2. Next, you'll need to measure how deep to place your brackets in the window. Starting at one of your marks, measure back at least 2 1/4", and make a mark with your pencil. If you want the front of the cassette to be flush with the wall, measure back 3" and make a mark. Repeat this step until you've marked the same depth measurement for each bracket.

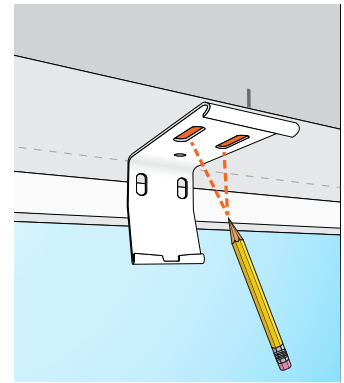
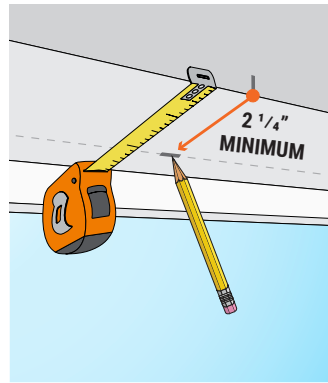

3. Position a bracket at the top of the window so that the back aligns with your mark. Make sure the front end of the bracket is parallel with the top edge of the window, then use your pencil to mark where the screws will go. Repeat this step until you've marked the screw holes for each bracket.

4. Pre-drill the screw holes with a 5/64" drill bit at your marks for each bracket location. Before you mount the brackets, you may want to erase any pencil marks that remain on the wall or window.

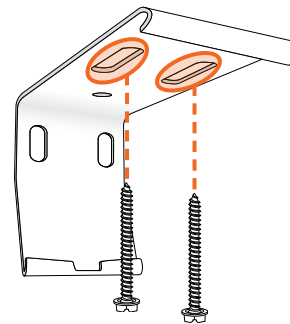

5. Line up your first bracket with the screw holes, and insert two screws to secure the bracket to the mounting surface. Repeat this step for any remaining brackets. When all brackets are secure, the next step is to set the roller shade in the window (see page 10).

CASSETTE HEADRAIL - OUTSIDE MOUNT

1. At the top corners of the window, measure inward and mark with your pencil 2" - 4" from each side. If you have additional brackets, make an additional mark for each one, evenly spaced between the outer marks.



2. From one of these marks, measure upward and mark the height for the bracket placement. The minimum requirement is 1 1/2", but if you want the brackets to clear the top of the window, measure and mark at least 2" above your window. Repeat this until you've marked the same height measurement for each bracket.

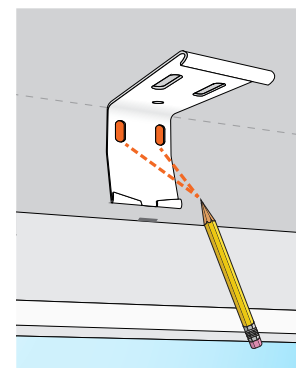
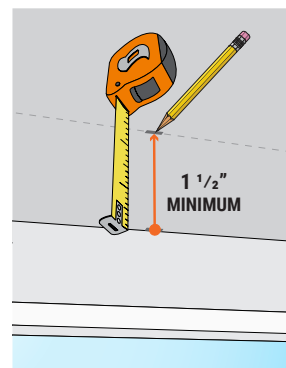

3. Position a bracket so that the back is against your mounting surface, and the top is aligned with one of your upper marks. Hold the bracket in place and mark with your pencil where the screws will go. Repeat this until you've marked the screw holes for each bracket.

4. Pre-drill the screw holes with a 5/64" drill bit at your marks for each bracket location. Before you mount the brackets, you may want to erase any pencil marks that remain on the mounting surface.

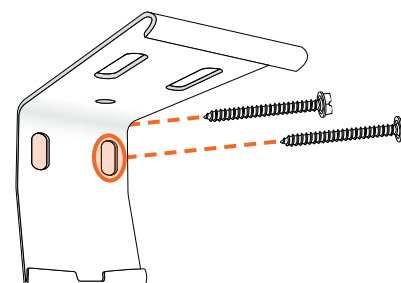

5. Line up your first bracket with the screw holes, and insert two screws to secure the bracket to the mounting surface. Repeat this step for any remaining brackets. When all brackets are secure, the next step is to set the roller shade in the window (see page 10).

2. ATTACHING THE SHADE

NOTE: Before you attach the shade to the brackets, check that your brackets are straight and aligned with each other. The screw holes on all brackets are elongated, so making small adjustments is easy. Once your roller shade is installed into your brackets, you can safely remove the paper band wrapped around the roller.

Inside Mount: Use a tape measure to check that each bracket is set to the same depth. If you need to make adjustments, slightly loosen the screws on a bracket and shift it back or forward. Secure the screws when the position is corrected.

Outside Mount: Use a tape measure to check that each bracket is set to the same height, and use a level on top of each bracket to make sure they're all straight and aligned. If you need to make adjustments, slightly loosen the screws on a bracket and shift it until it's level and set to the correct height.

STANDARD EXPOSED ROLL CORDLESS LIFT

1. Locate the square-shaped peg on the left end of the roller. While holding the shade in your hands, fit the square peg into the square hole in the idle bracket.

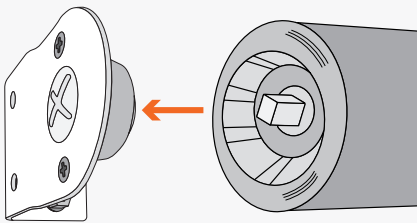

2. While keeping the left end attached to the bracket, insert the pin on the right end of the shade through the pinhole in the right-side bracket. You may need to compress the pin to fit it into the bracket.

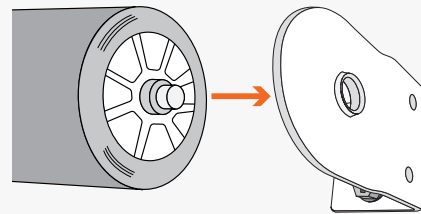

REVERSE EXPOSED ROLL CORDLESS LIFT

1. Locate the square-shaped peg on the right end of the roller. While holding the shade in your hands, fit the square peg into the square hole in the idle bracket.

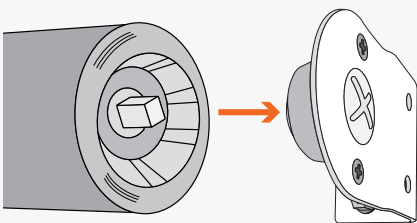

2. While keeping the left end attached to the bracket, insert the pin on the right end of the shade through the pinhole in the right-side bracket. You may need to compress the pin to fit it into the bracket.

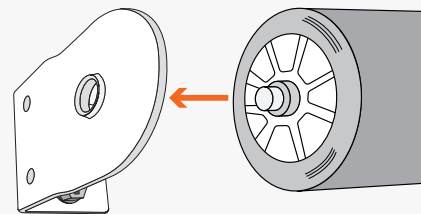

CASSETTE HEADRAIL PREMIUM CORDLESS LIFT

1. Grab the cassette and hold it up to your brackets. Set the back edge of the headrail onto the bottom tab of each bracket. While in this position, you can slide the shade left or right until the cassette is centered.

2. When you're ready to secure the headrail, push the headrail back until the top of each bracket snaps onto the top of the cassette.

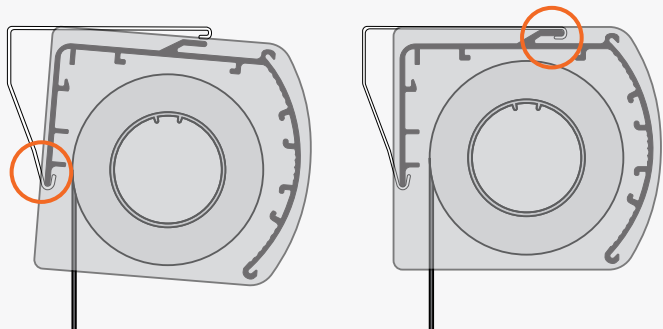

3. ADDITIONAL INSTRUCTIONS

HOW TO OPERATE

NOTE: Do not pull on the side of the shade fabric; this can cause the fabric to misalign or become dirty. A cordless roller shade should only be operated by pulling from the clear plastic handle on the bottom hem bar.

1. To lower the shade, grip the handle and gently pull straight down to the desired position.
2. To raise the shade, grip the handle and gently tug down to release the lock mechanism.
 - A. If you have a **STANDARD CORDLESS** shade, slowly guide the shade up *without releasing your grip*, and gently tug down to lock the shade in position.
 - B. If you have a **PREMIUM CORDLESS** shade, you may release the handle(s) and allow the shade to raise itself to the top of the window.

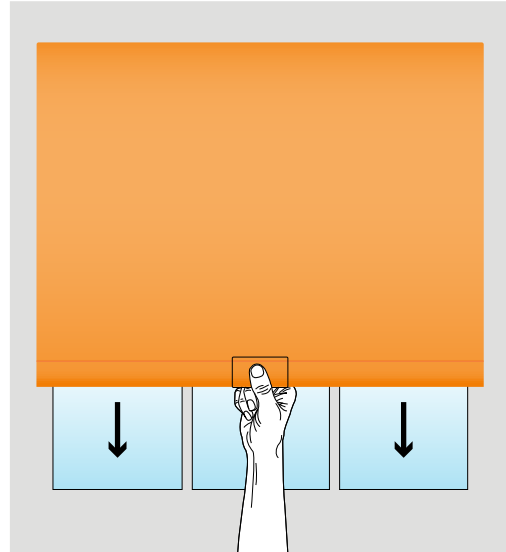

ADJUSTING TENSION

NOTE: You can change the speed of your shade by adjusting the spring tension. If the shade is too slow, increase the tension; if the shade is too fast, decrease tension. Choose the method below that matches your lift system and mount type.

Standard Cordless Lift - Inside Mount

1. Lower the shade if you need to increase tension, or leave it up if you need to decrease tension.
2. Remove the shade by disengaging the pin from the pin bracket, and then shifting the roller away from the idle bracket. You may need a flathead screwdriver to disengage the pin.
3. To increase tension, carefully roll up the shade with your hands and reinstall it to the brackets. To decrease tension, carefully unroll the shade with your hands and reinstall it to the brackets. Repeat these steps until you've reached the desired tension.

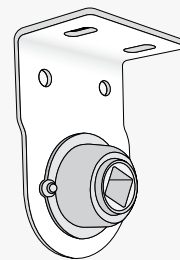

IDLE BRACKET

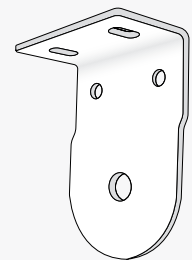

PIN BRACKET

Standard Cordless Lift - Outside Mount

NOTE: Use a flathead screwdriver when adjusting the tension, to avoid stripping the plastic screw.

1. Locate the plastic adjustment screw on the end of your shade. This is on the left end for Standard Roll Position, and on the right end for Reverse Roll Position (see page 6).
2. Turn the screw clockwise to increase tension, or turn it counterclockwise to decrease tension. It is recommended to only use 1/4 and 1/2 turns until the desired tension is reached.

INCREASING TENSION (CLOCKWISE)

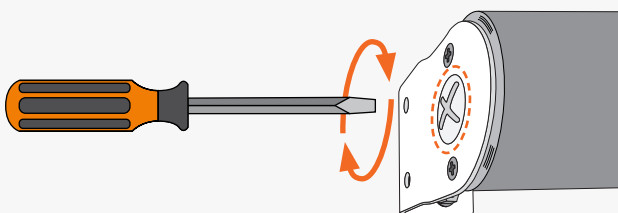

DECREASING TENSION (COUNTERCLOCKWISE)

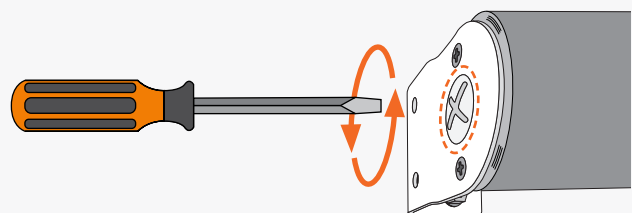

Premium Cordless Lift - Inside and Outside Mount

NOTE: If your cassette is installed inside the window, remove it from the brackets before you proceed.

1. Remove the end cap from the left end of the cassette headrail. This will expose a plastic adjustment screw, which you can turn with a flathead screwdriver to adjust the speed of your shade.
2. Turn the plastic adjustment screw clockwise to increase tension, or counter-clockwise to decrease tension. Use 1/4 and 1/2 turns until the desired tension is reached.

INCREASING TENSION (CLOCKWISE)

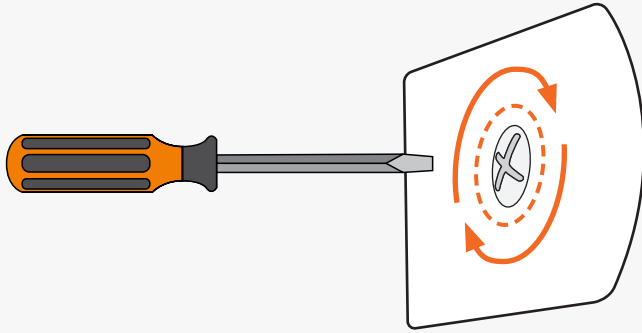

DECREASING TENSION (COUNTERCLOCKWISE)

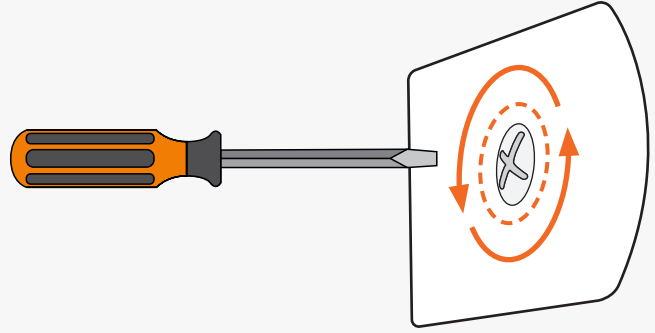

ADJUSTING MISALIGNED FABRIC

TIP: If your shade doesn't roll straight, first make sure the brackets are level. If it veers to the right, lower the shade completely and place a piece of tape or business card as close to the left edge of the roller as possible. This acts like a shim to align and straighten the shade. If it veers to the left, place the tape or card as close to the right edge as you can. Repeat this tip until the shade raises and lowers evenly.

CLEANING INSTRUCTIONS

NOTE: All fabrics are different and some may be easier to clean than others. We recommend cleaning your shades as often as once a month. Here are some general guidelines on how to do so:

1. For regular maintenance, use a duster or a vacuum with a brush attachment and run it over the front and back of the shade.
2. To spot clean stains, use a damp rag with a very mild, gentle detergent or soap. Dab at the affected spots; do NOT rub! Let the dampened area air-dry and repeat as necessary.

WARRANTY AND REPLACEMENT

To learn more about our product warranties, please visit: <https://www.selectblindscanada.ca/warranty>

For replacement parts, and/or to file a warranty claim for a product that is damaged, defective, or missing parts, please call our Customer Care Team at 888-685-1735, or email info@selectblindscanada.ca.

CHILD SAFETY WARNING

⚠ WARNING

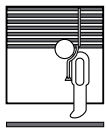

Corded window blinds and shades can be a strangulation risk or cause serious injury to young children and pets. When using corded window treatments, use the following tips to keep them safe:

- Move furniture that children can climb on away from the window.
- **NEVER** place a crib by a window!
- Keep cords up and away from your child's reach.
- Always use cord cleats with corded products.
- Secure child-safe tensioners for continuous cord loop chains to the wall or window encasement.